

High lift system (HL)

Max. W x H 5000x5000

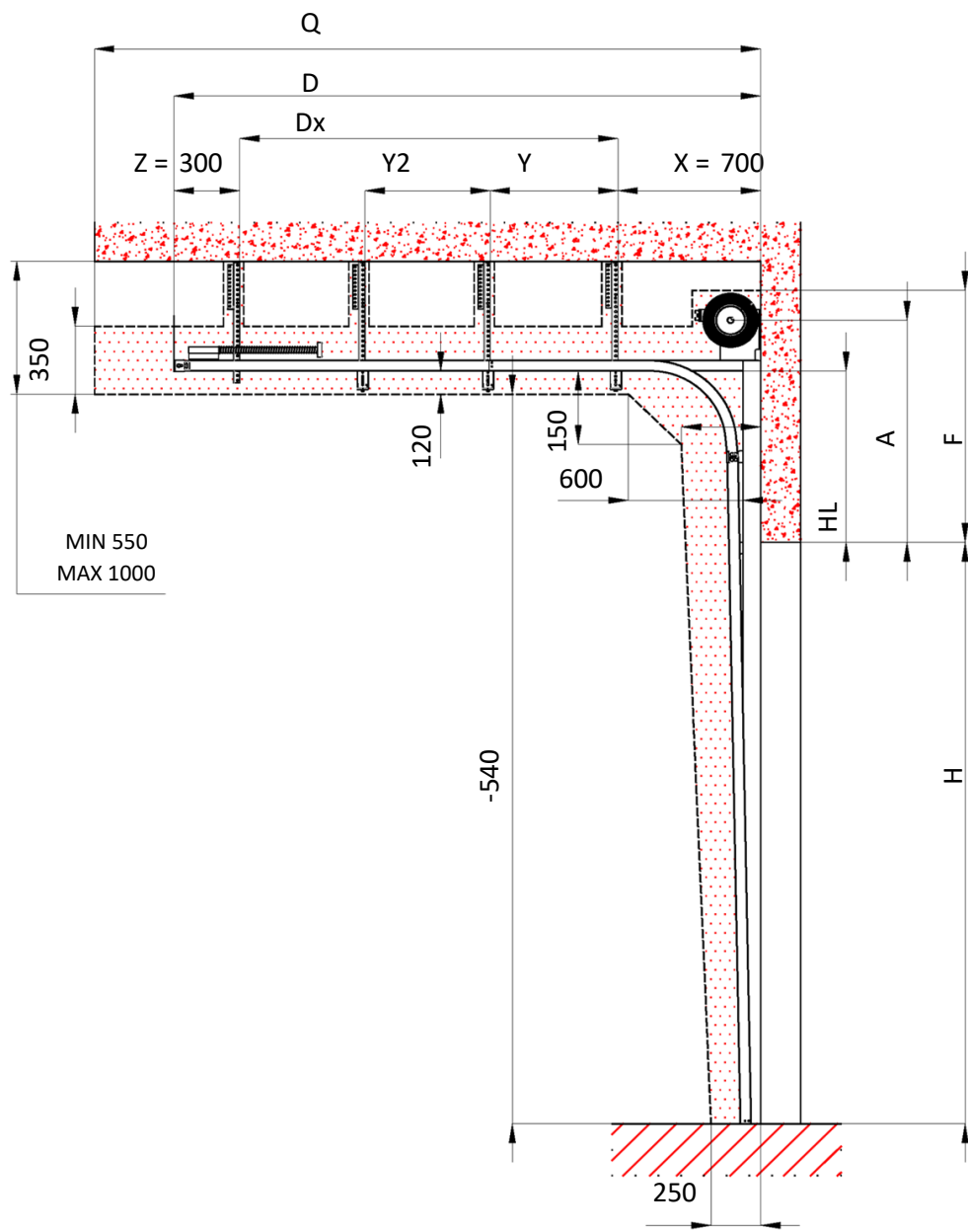

- Opening width mm
- Opening height mm
- Free room above lintel mm
- Position of motor

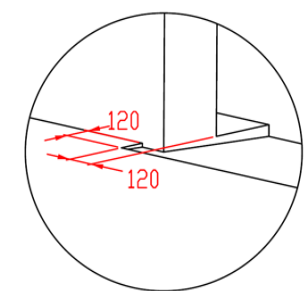

Fall of the floor

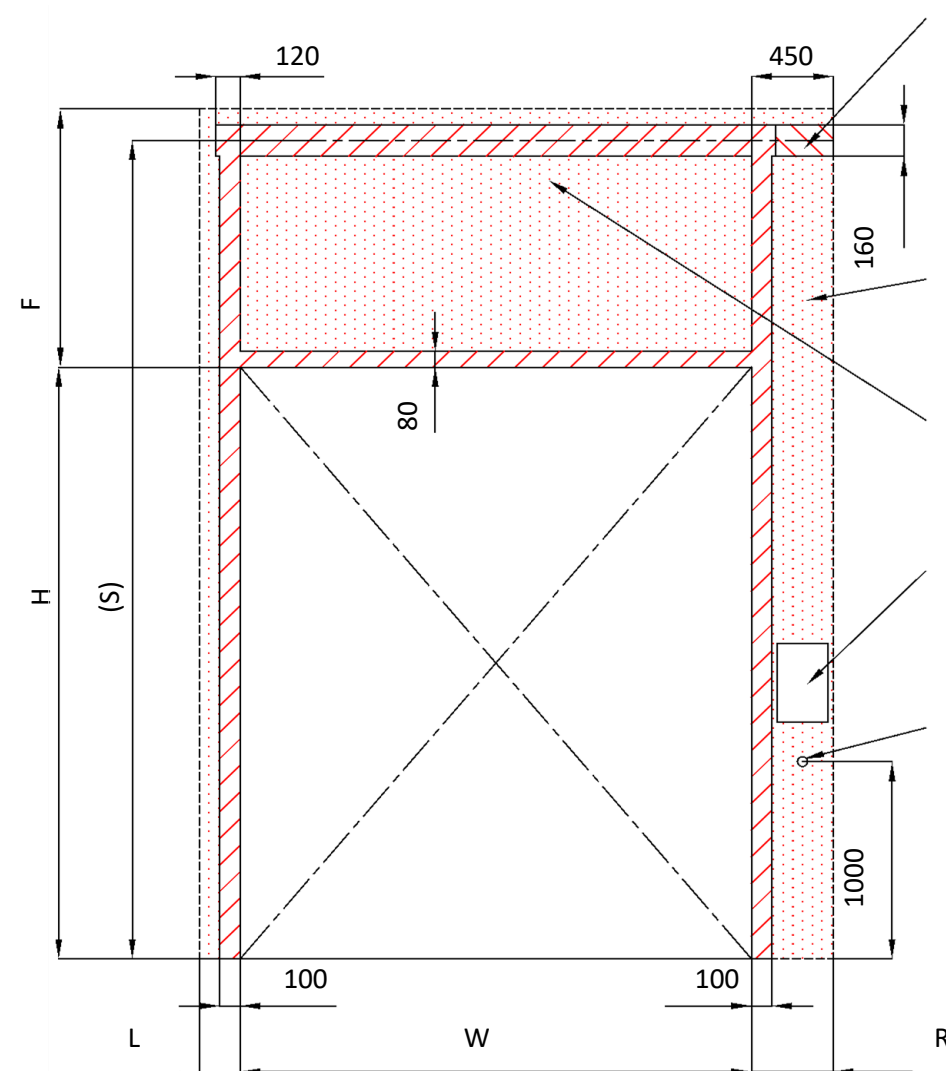
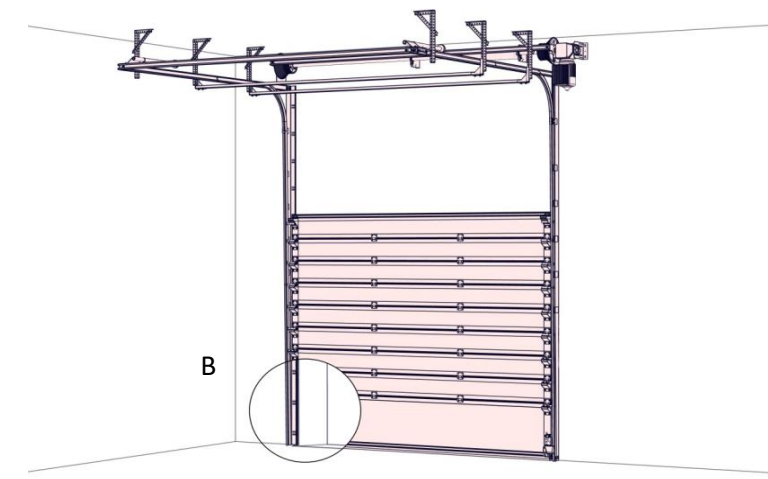
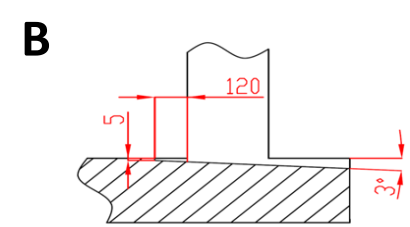

- Mounting surface for motor (L or R)
- Necessary side room for electrical- operation (L or R)
- Necessary free room
- Mounting surface for control panel dimensions 210 x 550 mm Bottom edge 1500mm from floor
- Industrial electric outlet cee 20A, 5P, 400 V, protected by 20A circuit breaker, residual current device I=30 mA.

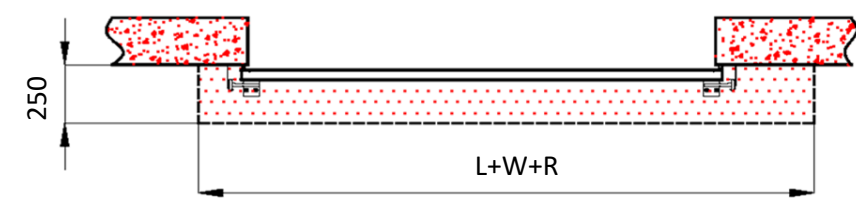
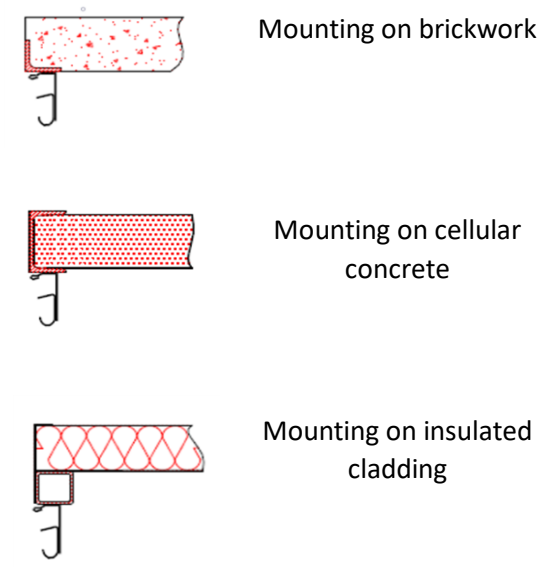

Note:
Mounting surface must be flat and massive and all mounting surfaces must be in one level.
Furthermore the opening must be plumb and square.

Interior view

Units in mm			
W	Opening width		
H	Opening height		
F	Free room above lintel		0
HL	High lift	F-420	-420
A	Height of shaft above lintel	HL+260	-160
L	Free side room left		0
R	Free side room right		0
D	Back room length of horizontal track	H-HL+1250	
X	1st hanging point		700
Y	2nd hanging point	1/2 Dx	
Y2	3rd hanging point	2/3 Dx	
Z	4th hanging point		300
Q	Free space depth (back room)	D+400	
S	Shaft Axis over Floor	(H+A)	
L/R	Position of motor		min. 400

- Necessary free room
- Necessary mounting surface
- Mounting surface for motor (L or R)

Work to be carried out by customer, unless in advance otherwise is agreed in writing.

Supply and fix mounting frame and mounting surfaces for the rails and the spring packet in case of aerated concrete or sandwichpanels etc.

Necessary mounting surface and free room as shown.

Electrical supply required to be :
Industrial electric outlet cee 20A, 5P, 400 V, protected by 20A circuit breaker, residual current device I=30 mA.

Revision date 04.01.2023 Sheet: A3
Version: 2309